

**ORDINANCE NO. 1373**

AN ORDINANCE ANNEXING THE FOLLOWING UNINCORPORATED AREA OF BAY COUNTY WHICH IS CONTIGUOUS TO THE CITY OF PANAMA CITY BEACH, FLORIDA, UPON PETITION OF THE OWNERS OF SAID PROPERTY LOCATED AT 8752 THOMAS DRIVE AND 3011 JOAN AVENUE, NEAR THE NORTHWEST CORNER OF THE INTERSECTION OF JOAN AVENUE AND THOMAS DRIVE; SAID PARCELS CONTAINING 4.43 ACRES MORE OR LESS; REDEFINING THE BOUNDARY LINES OF THE CITY; PROVIDING THAT THIS ORDINANCE SHALL TAKE EFFECT IMMEDIATELY UPON PASSAGE.

WHEREAS, Seahaven Construction LLC and Dennis Pledger, owners of real property in an unincorporated area of Bay County which is contiguous to this City, have filed a petition on the 24th day of September, 2015, praying that said real property, being more particularly described below, be annexed to this City, and

WHEREAS, the City Council of this City has determined that the petition bears the signatures of all the owners of the property in the area proposed to be annexed, and

WHEREAS, Notice of Voluntary Annexation for this property has been published in the Panama City News-Herald once a week for two (2) consecutive weeks prior to this date, the same being a newspaper of general circulation in this City.

NOW, THEREFORE, BE IT ENACTED BY THE PEOPLE OF THE CITY OF PANAMA CITY BEACH, FLORIDA:

Section 1. It is hereby annexed and made a part of the City of Panama City Beach, Florida, the following described lands in Bay County, Florida, to-wit:

SEE EXHIBIT "A" ATTACHED HERETO

Section 2. The boundary lines of the City of Panama City Beach, Florida, are redefined to include therein said tract of land.

Section 3. A map of the area to be annexed is attached.

Section 4. This ordinance shall take effect immediately upon passage.

PASSED, APPROVED AND ADOPTED at the regular meeting of the City Council of the City of Panama City Beach, Florida, this 14<sup>th</sup> day of January, 2016.

Gayle F. Oberst  
Gayle F. Oberst, Mayor

ATTEST:

Diane B. Fowler  
Diane Fowler, City Clerk

EXAMINED AND APPROVED by me this 14<sup>th</sup> day of January, 2016.

Gayle F. Oberst  
Mayor

PUBLISHED in the Panama City News-Herald on the 28<sup>th</sup> day of December, 2015 and the 4<sup>th</sup> day of January, 2016.  
POSTED on pcb.gov.com on the 18<sup>th</sup> day of January, 2016 <sup>(LSS)</sup>

Diane B. Fowler  
Diane Fowler, City Clerk

**ATTACHMENT TO ORDINANCE NO. 1373**

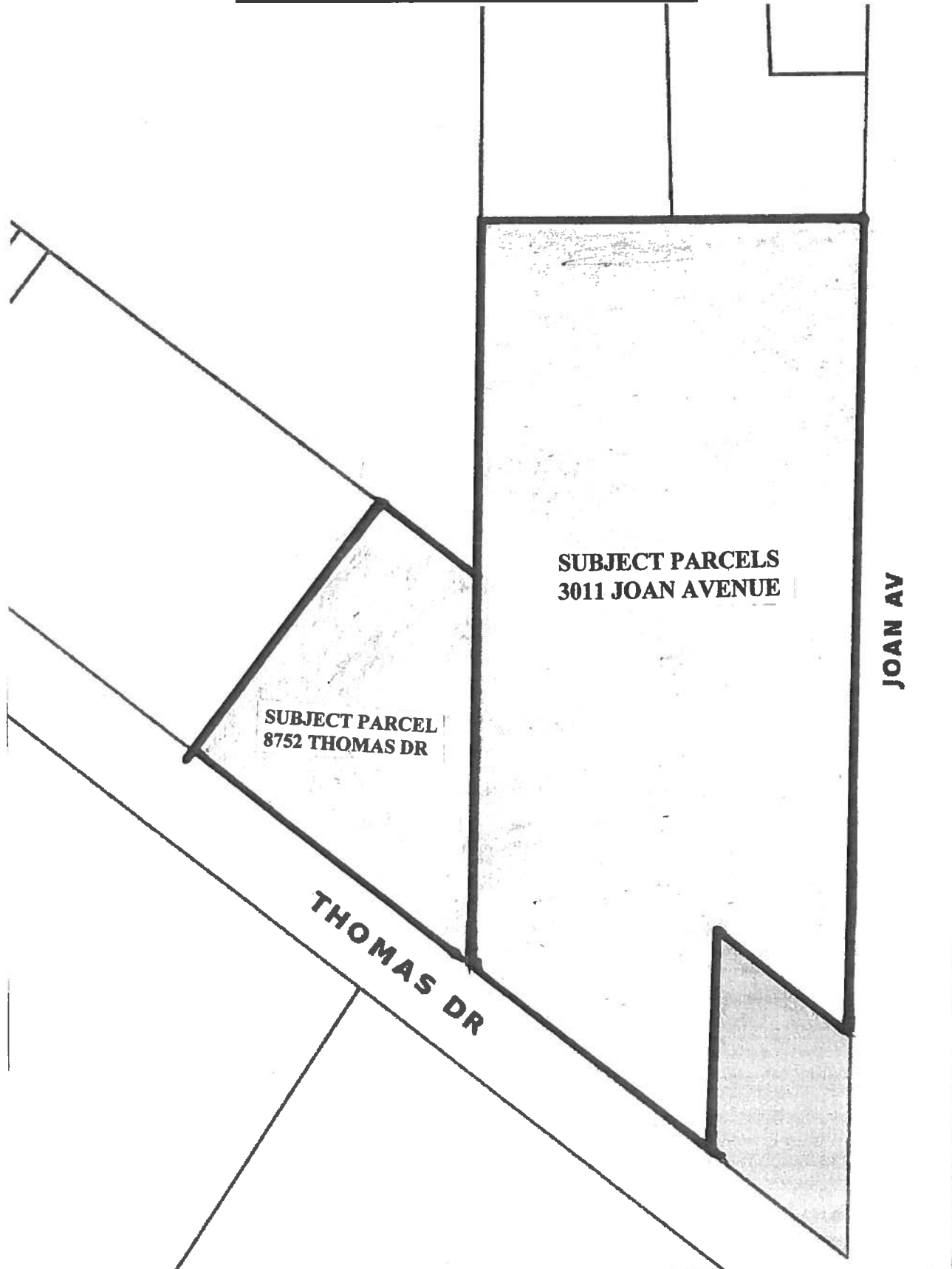

PARCEL 1:

BEGIN AT THE INTERSECTION OF THE EAST LINE OF GOVERNMENT LOT 8, SUPPLEMENTAL PLAT 1920, ALSO KNOWN AS GOVERNMENT LOT 12 ACCORDING TO CHANGES DATED JUNE 17, 1916 AND ALSO KNOWN AS GOVERNMENT LOT 8 ACCORDING TO PLAT DATED JANUARY 29, 1902, SECTION 6, TOWNSHIP 4 SOUTH, RANGE 15 WEST, BAY COUNTY FLORIDA WITH THE NORTHERLY RIGHT OF WAY LINE OF THOMAS DRIVE (STATE ROAD NO. 392, A 100 FOOT RIGHT OF WAY ); THENCE NORTH 52°44'23" WEST ALONG SAID NORTHERLY RIGHT OF WAY LINE FOR 243.73 FEET; THENCE NORTH 37°15'37" EAST FOR 215.00 FEET; THENCE SOUTH 52°44'23" EAST FOR 80.77 FEET TO THE EAST LINE OF SAID GOVERNMENT LOT 8; THENCE SOUTH 00°05'57" WEST ALONG SAID EAST LINE FOR 269.78 FEET TO THE POINT OF BEGINNING. sm/ck

PARCEL A:

COMMENCE AT THE POINT OF INTERSECTION OF THE WEST R/W LINE OF JOAN AVENUE (STATE ROAD NO. S-30-B) AND THE NORTHEASTERN R/W LINE OF THOMAS DRIVE (STATE ROAD NO. 392) AND THENCE RUN N 52°44'23" W ALONG SAID NORTHEASTERN R/W LINE OF THOMAS DRIVE FOR 125.00 FEET TO THE POINT OF BEGINNING; THENCE CONTINUE N 52°44'23" W ALONG SAID R/W LINE FOR 207.59 FEET TO A POINT ON THE WESTERN BOUNDARY LINE OF ORIGINAL GOVERNMENT LOT 7 IN FRACTIONAL SECTION 6, TOWNSHIP 4 SOUTH, RANGE 15 WEST; THENCE N 00°05'27" E ALONG SAID WESTERN BOUNDARY LINE FOR 250.00 FEET; THENCE S 52°40'46" E FOR 182.34 FEET; THENCE S 00°01'05" W FOR 100.00 FEET; THENCE S 52°44'23" E FOR 25.00 FEET; THENCE S 00°01'05" W FOR 150.00 FEET TO THE POINT OF BEGINNING. SAID LANDS BEING IN FRACTIONAL SECTION 6, TOWNSHIP 4 SOUTH, RANGE 15 WEST, BAY COUNTY, FLORIDA. sm/ck

PARCEL B:

COMMENCE AT THE POINT OF INTERSECTION OF THE WEST R/W LINE OF JOAN AVENUE (STATE ROAD NO. S-30-B) AND THE NORTHEASTERN R/W LINE OF THOMAS DRIVE (STATE ROAD NO. 392) AND THENCE N 00°01'05" E ALONG SAID WEST R/W LINE OF JOAN AVENUE FOR 150.00 FEET TO THE POINT OF BEGINNING; THENCE CONTINUE N 00°01'05" E ALONG SAID R/W LINE FOR 250.00 FEET; THENCE N 78°57'55" W FOR 269.38 FEET TO A POINT ON THE WEST BOUNDARY LINE OF ORIGINAL GOVERNMENT LOT 7, FRACTIONAL SECTION 6, TOWNSHIP 4 SOUTH, RANGE 15 WEST; THENCE S 52°40'46" E FOR 182.34 FEET; THENCE S 00°01'05" W FOR 100.00 FEET; THENCE S 52°44'23" E FOR 150.00 FEET TO THE POINT OF BEGINNING. SAID LANDS BEING IN FRACTIONAL SECTION 6, TOWNSHIP 4 SOUTH, RANGE 15 WEST, BAY COUNTY, FLORIDA. sm/ck

PARCEL D:

COMMENCE AT THE POINT OF INTERSECTION OF THE WEST R/W LINE OF JOAN AVENUE (STATE ROAD NO. S-30-B) AND THE NORTHEASTERN R/W LINE OF THOMAS DRIVE (STATE ROAD NO. 392); THENCE N 00°01'05" E ALONG SAID WEST R/W LINE OF JOAN AVENUE FOR 400.00 FEET TO THE POINT OF BEGINNING; THENCE CONTINUE N 00°01'05" E ALONG SAID WEST R/W LINE FOR 320.00 FEET; THENCE S 85°57'50" W FOR 264.71 FEET TO THE WEST LINE OF ORIGINAL GOVERNMENT LOT 7, FRACTIONAL SECTION 6, TOWNSHIP 4 SOUTH, RANGE 15 WEST; THENCE S 00°05'42" W ALONG SAID WEST LINE OF ORIGINAL GOVERNMENT LOT 7 FOR 250.02 FEET TO THE MOST NORTHERLY CORNER OF THE PARCEL DESCRIBED IN OFFICIAL RECORDS BOOK 1105, PAGE 1968 OF THE PUBLIC RECORDS OF BAY COUNTY, FLORIDA; THENCE S 78°57'55" E FOR 269.38 FEET TO THE POINT OF BEGINNING. sm/ck