

*STATE OF FLORIDA*  
*DEPARTMENT OF TRANSPORTATION*

*CONTRACT PLANS*

*INDEX OF SIGNING & PAVEMENT MARKING PLANS*

SHEET NO.	SHEET DESCRIPTION
S-1	KEY SHEET
S-2	TABULATION OF QUANTITIES
S-3 - S-10	SIGNING & PAVEMENT MARKING PLANS

FINANCIAL PROJECT ID 441742-2-58-01 & 441742-2-58-02

FEDERAL FUNDS

BAY COUNTY (46590000)

ALF COLEMAN RD.

FROM SR 392A (MIDDLE BEACH RD.) TO SR 30A/US 98 (BACK BEACH RD.)

*SIGNING AND PAVEMENT MARKING PLANS*

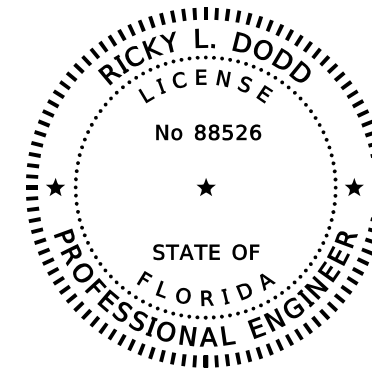
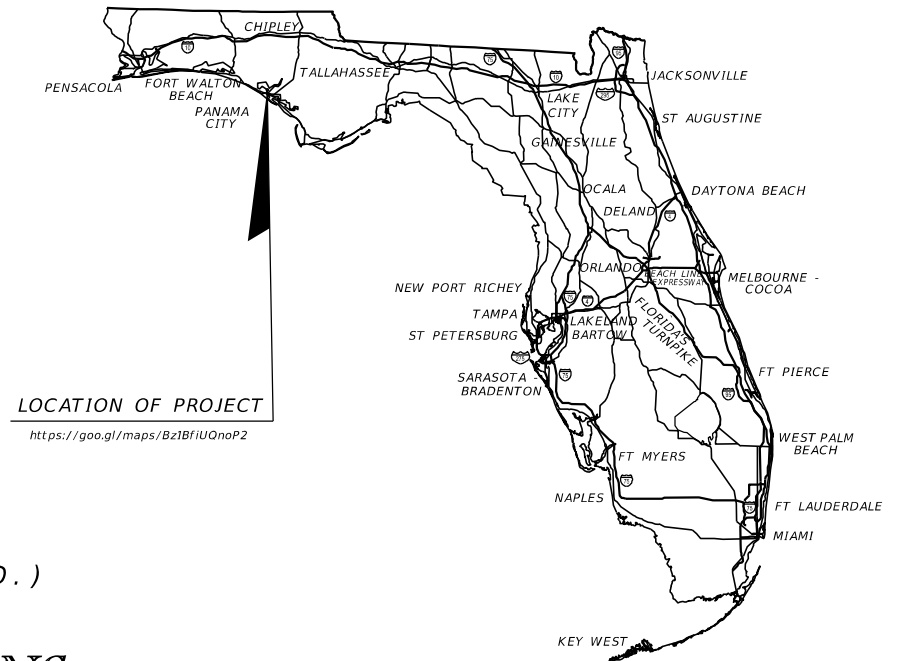

THIS ITEM HAS BEEN DIGITALLY  
SIGNED AND SEALED BY

ON THE DATE ADJACENT TO THE SEAL

PRINTED COPIES OF THIS DOCUMENT ARE  
NOT CONSIDERED SIGNED AND SEALED  
AND THE SIGNATURE MUST BE VERIFIED  
ON ANY ELECTRONIC COPIES.

**SIGNING & PAVMENT MARKINGS  
ENGINEER OF RECORD:**

RICKY L. DODD  
P.E. NO.: 88526  
GREENMAN-PEDERSEN, INC.  
1273 OFFICE PARK DR.  
CHIPLEY, FLORIDA 32428  
(850) 668-5211

VENDOR NUMBER: F11-2537074  
CONTRACT NUMBER: CA054  
REGISTRY NUMBER: 3498

**FDOT PROJECT MANAGER:**

JIMMY SMITH, P.E.  
(850) 372-4126

CONSTRUCTION CONTRACT NO.	FISCAL YEAR	SHEET NO.
N/A	20	S-1

THE OFFICIAL RECORD OF THIS SHEET IS THE ELECTRONIC FILE DIGITALLY SIGNED AND SEALED UNDER RULE 61G15-23.004, F.A.C.

TABULATION OF QUANTITIES

FPID: 441742-2-58-01

PAY ITEM NO.	DESCRIPTION	UNIT	SHEET NUMBERS																TOTAL THIS SHEET		GRAND TOTAL		
			S-3		S-4		S-5		S-6		S-7		S-8		S-9		S-10		PLAN	FINAL	PLAN	FINAL	
			PLAN	FINAL	PLAN	FINAL	PLAN	FINAL	PLAN	FINAL	PLAN	FINAL	PLAN	FINAL	PLAN	FINAL							
700-1-50	SINGLE POST SIGN, RELOCATE	AS					2		3		1		1							7			
711-11-123	THERMOPLASTIC, STANDARD, WHITE, SOLID, 12" FOR CROSSWALK	LF	174.1				203.2					136.8				172.7		200.4		887			
711-14-125	THERMOPLASTIC, PREFORMED, WHITE SOLID, 24" FOR CROSSWALK	LF	73.9															136.0		136			

TABULATION OF QUANTITIES

FPID: 441742-2-58-02

PAY ITEM NO.	DESCRIPTION	UNIT	SHEET NUMBERS																TOTAL THIS SHEET		GRAND TOTAL		
			S-3		S-4		S-5		S-6		S-7		S-8		S-9		S-10		PLAN	FINAL	PLAN	FINAL	
			PLAN	FINAL	PLAN	FINAL	PLAN	FINAL	PLAN	FINAL	PLAN	FINAL	PLAN	FINAL	PLAN	FINAL							
700-1-50	SINGLE POST SIGN, RELOCATE	AS			1										2		1			4			
710-90	PAINTED PAVEMENT MARKINGS - FINAL SURFACE	LS																					
*	REFLECTIVE PVMNT MARKERS																						
*	BI-DIR. YELLOW	EA	10		52		57		80		80		51		48		10		388				
*	BI-DIR. WHITE/RED	EA	9		2				2		11		14		33		37		108				
*	PAINTED PVMNT MARKINGS, WHITE, SOLID 6"	GM	0.082		0.161		0.108		0.178		0.186		0.191		0.170		0.191		1.267				
*	PAINTED PVMNT MARKINGS, WHITE, SOLID 12"	LF	174.2				203.2				136.8				172.7		200.4		887				
*	PAINTED PVMNT MARKINGS, WHITE, SOLID 18"	LF													53.4		95.1		148				
*	PAINTED PVMNT MARKINGS, WHITE, SOLID 24"	LF	94.1				63.9				22.9						186.5		367				
*	PAINTED PVMNT MARKINGS, ARROWS																						
*	(LEFT DIRECTIONAL)	EA	1		1						1		2		1		4		10				
*	(RIGHT TURN-THRU DIRECTIONAL)	EA	1		1														2				
*	(RIGHT DIRECTIONAL)	EA									2		2		2		2		8				
*	(THRU)	EA															2		2				
	TOTAL		2		2						3		4		3		8		22				
*	PAINTED PVMNT MARKINGS, MESSAGE (ONLY)	EA															1		1				
*	PAINTED PVMNT MARKINGS, YELLOW, SOLID 6"	GM	0.064		0.238		0.148		0.255		0.256		0.214		0.202		0.071		1.448				
*	PAINTED PVMNT MARKINGS, YELLOW, SOLID 18"	LF			76.9		11.7		86.2		89.4		97.3		76.5				438				
711-11-124	THERMOPLASTIC, STANDARD, WHITE, SOLID, 18" FOR DIAGONALS AND CHEVRONS	LF													53.4		95.3		149				
711-11-125	THERMOPLASTIC, STANDARD, WHITE, SOLID, 24" FOR STOP LINE AND CROSSWALK	LF	20.2				63.9				22.9						50.5		158				
711-11-160	THERMOPLASTIC, STANDARD, WHITE, MESSAGE	EA															1		1				
711-11-170	THERMOPLASTIC, STANDARD, WHITE, ARROW	EA	2		2						3		4		3		8		22				
711-11-224	THERMOPLASTIC, STANDARD, YELLOW, SOLID, 18" FOR DIAGONAL OR CHEVRON	LF			76.9		11.7		86.2		89.4		97.3		76.5				438				
711-16-101	THERMOPLASTIC, STANDARD-OTHER SURFACES, WHITE, SOLID, 6"	GM	0.082		0.161		0.108		0.178		0.186		0.191		0.170		0.191		1.267				
711-16-102	THERMOPLASTIC, STANDARD-OTHER SURFACES, WHITE, SOLID, 8"	GM													0.025		0.006		0.031				
711-16-201	THERMOPLASTIC, STANDARD-OTHER SURFACES, YELLOW, SOLID, 6"	GM	0.064		0.238		0.148		0.255		0.256		0.214		0.202		0.071		1.448				

\*THESE QUANTITIES ARE PAID FOR UNDER PAINTED PAVEMENT MARKINGS(FINAL SURFACE). LUMP SUM-ITEM NO. 710-90. THE QUANTITIES SHOWN ARE FOR ONE APPLICATIONS; SEE SPECIFICATION 710 FOR THE NUMBER OF APPLICATIONS REQUIRED.

REVISIONS				RICKY L. DODD, P.E. P.E. LICENSE NUMBER 88526 GREENMAN-PEDERSEN, INC. 1273 OFFICE PARK DR. CHIPLEY, FL 32428	STATE OF FLORIDA DEPARTMENT OF TRANSPORTATION			SHEET NO.  S-2
DATE	DESCRIPTION	DATE	DESCRIPTION		ROAD NO.	COUNTY	FINANCIAL PROJECT ID	
					N/A	BAY	441742-2-58-01	

TABULATION OF QUANTITIES

THE OFFICIAL RECORD OF THIS SHEET IS THE ELECTRONIC FILE DIGITALLY SIGNED AND SEALED UNDER RULE 61G15-23.004, F.A.C.

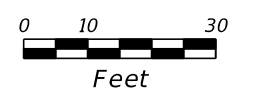
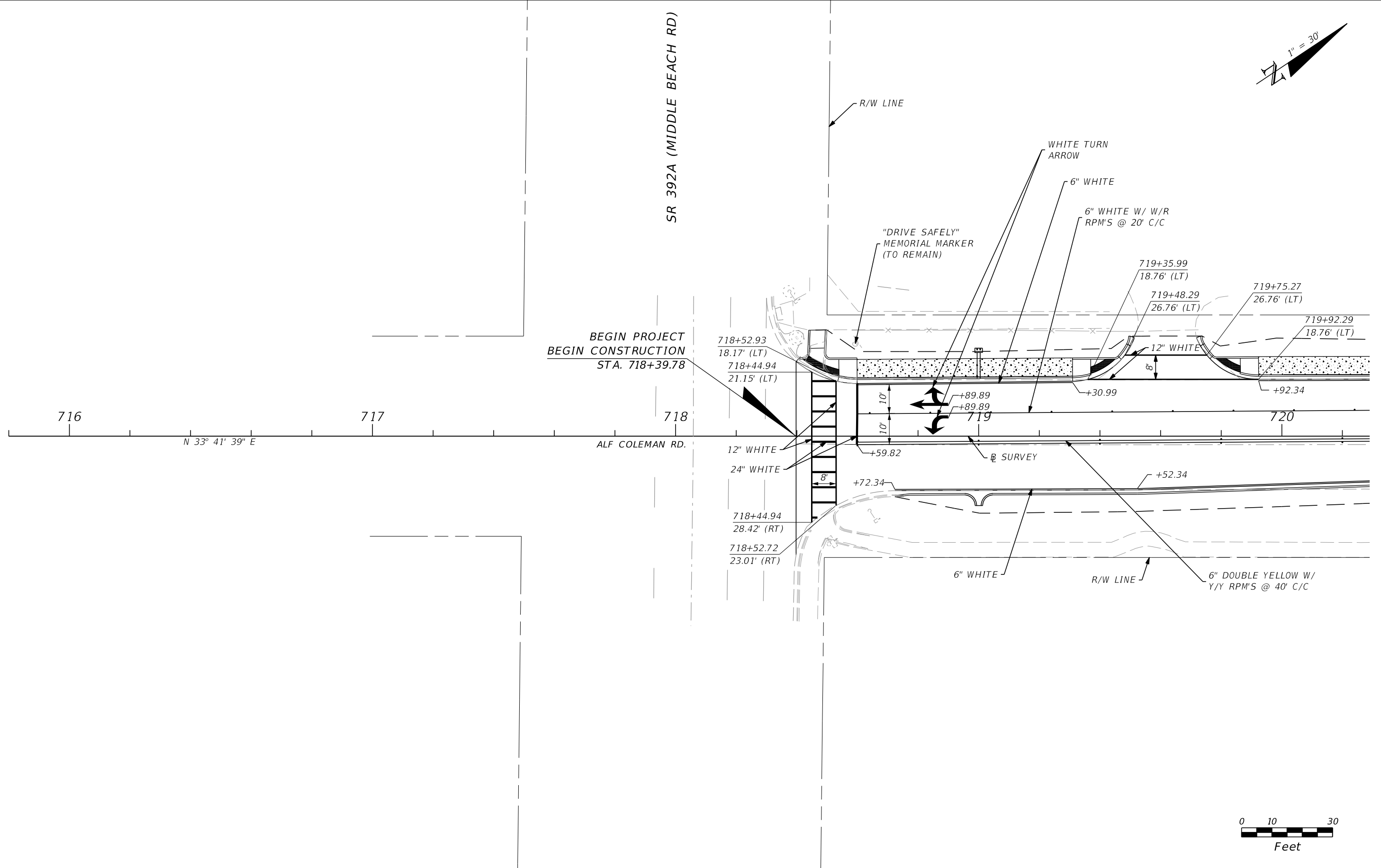
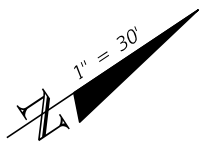

REVISIONS				RICKY L. DODD, P.E. P.E. LICENSE NUMBER 88526 GREENMAN-PEDERSEN, INC. 1273 OFFICE PARK DR. CHIPLEY, FL 32428	STATE OF FLORIDA DEPARTMENT OF TRANSPORTATION			<b>SIGING &amp; PAVEMENT                  MARKINGS</b>	SHEET NO.  S-3
DATE	DESCRIPTION	DATE	DESCRIPTION		ROAD NO.	COUNTY	FINANCIAL PROJECT ID		
					N/A	BAY	441742-2-58-01		

THE OFFICIAL RECORD OF THIS SHEET IS THE ELECTRONIC FILE DIGITALLY SIGNED AND SEALED UNDER RULE 61G15-23.004, F.A.C.

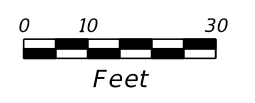
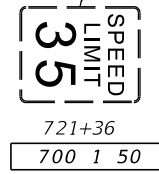
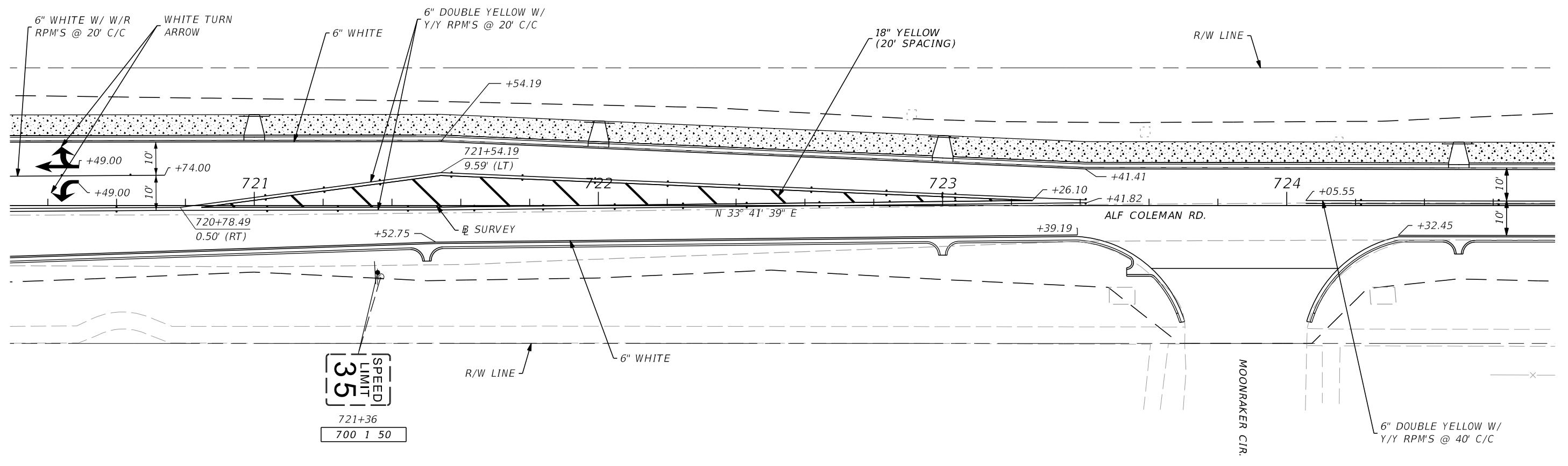
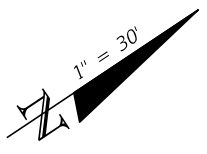

REVISIONS				RICKY L. DODD, P.E. P.E. LICENSE NUMBER 88526 GREENMAN-PEDERSEN, INC. 1273 OFFICE PARK DR. CHIPLEY, FL 32428	STATE OF FLORIDA DEPARTMENT OF TRANSPORTATION			<b>SIGNING &amp; PAVEMENT                  MARKINGS</b>	SHEET NO.
DATE	DESCRIPTION	DATE	DESCRIPTION		ROAD NO.	COUNTY	FINANCIAL PROJECT ID		
						N/A	BAY		441742-2-58-01

THE OFFICIAL RECORD OF THIS SHEET IS THE ELECTRONIC FILE DIGITALLY SIGNED AND SEALED UNDER RULE 61G15-23.004, F.A.C.

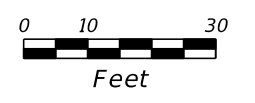
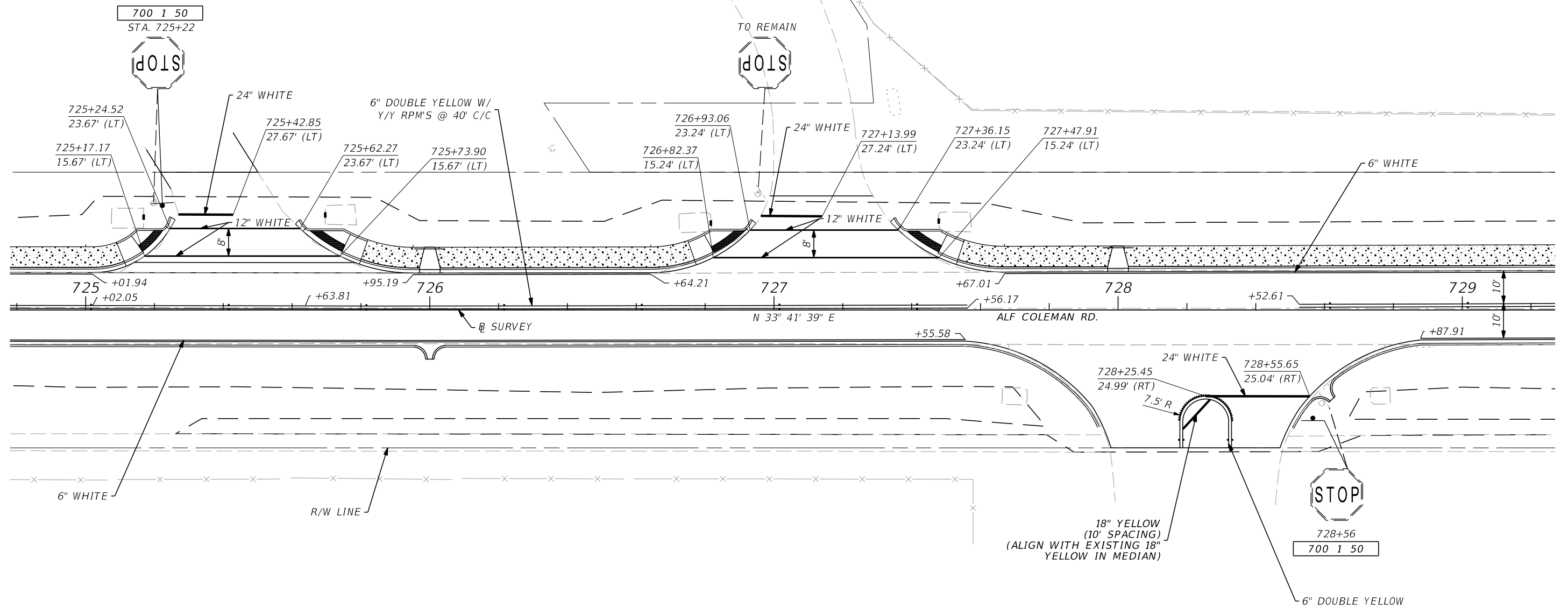
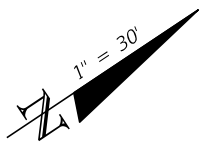

REVISIONS				RICKY L. DODD, P.E. P.E. LICENSE NUMBER 88526 GREENMAN-PEDERSEN, INC. 1273 OFFICE PARK DR. CHIPLEY, FL 32428	STATE OF FLORIDA DEPARTMENT OF TRANSPORTATION			<b>SIGNING &amp; PAVEMENT                  MARKINGS</b>	SHEET NO.  S-5
DATE	DESCRIPTION	DATE	DESCRIPTION		ROAD NO.	COUNTY	FINANCIAL PROJECT ID		
						N/A	BAY		441742-2-58-01

THE OFFICIAL RECORD OF THIS SHEET IS THE ELECTRONIC FILE DIGITALLY SIGNED AND SEALED UNDER RULE 61G15-23.004, F.A.C.

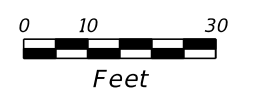
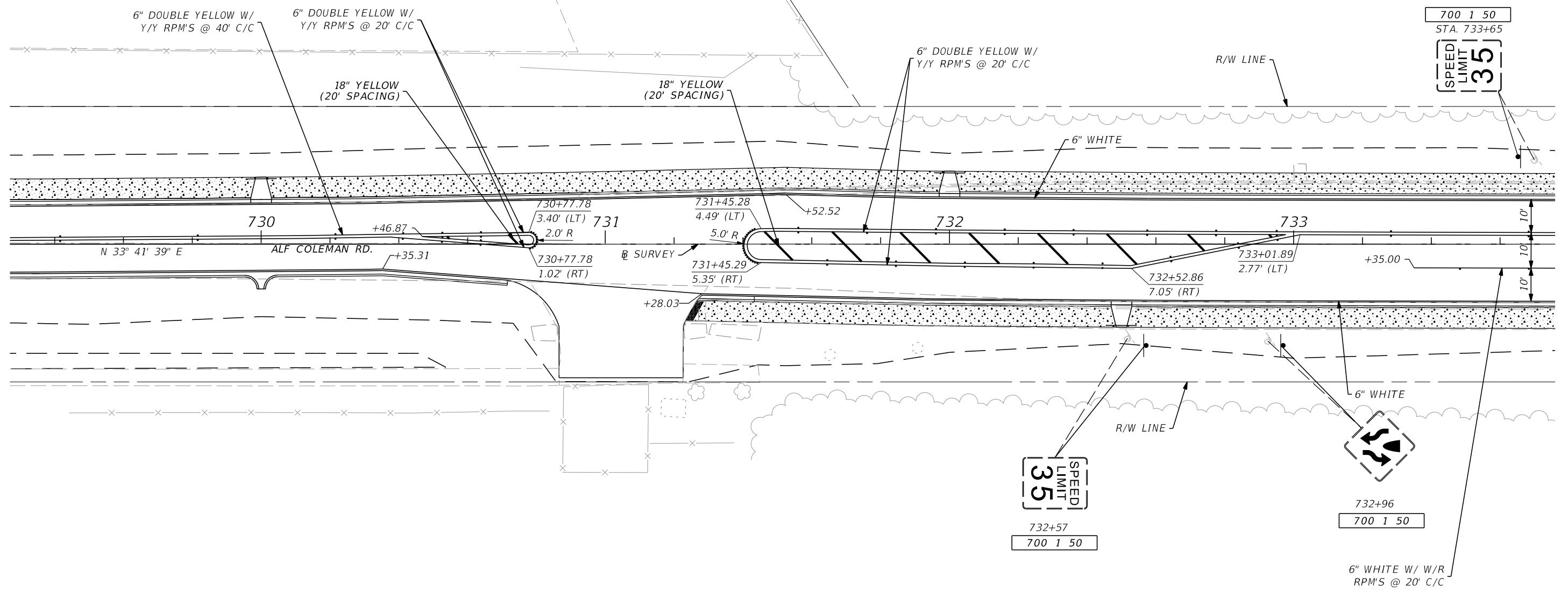
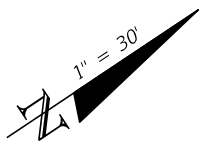

REVISIONS			
DATE	DESCRIPTION	DATE	DESCRIPTION

RICKY L. DODD, P.E.  
 P.E. LICENSE NUMBER 88526  
 GREENMAN-PEDERSEN, INC.  
 1273 OFFICE PARK DR.  
 CHIPLEY, FL 32428

STATE OF FLORIDA DEPARTMENT OF TRANSPORTATION		
ROAD NO.	COUNTY	FINANCIAL PROJECT ID
N/A	BAY	441742-2-58-01

**SIGNING & PAVEMENT  
MARKINGS**

SHEET NO.  
S-6

THE OFFICIAL RECORD OF THIS SHEET IS THE ELECTRONIC FILE DIGITALLY SIGNED AND SEALED UNDER RULE 61G15-23.004, F.A.C.

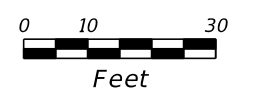
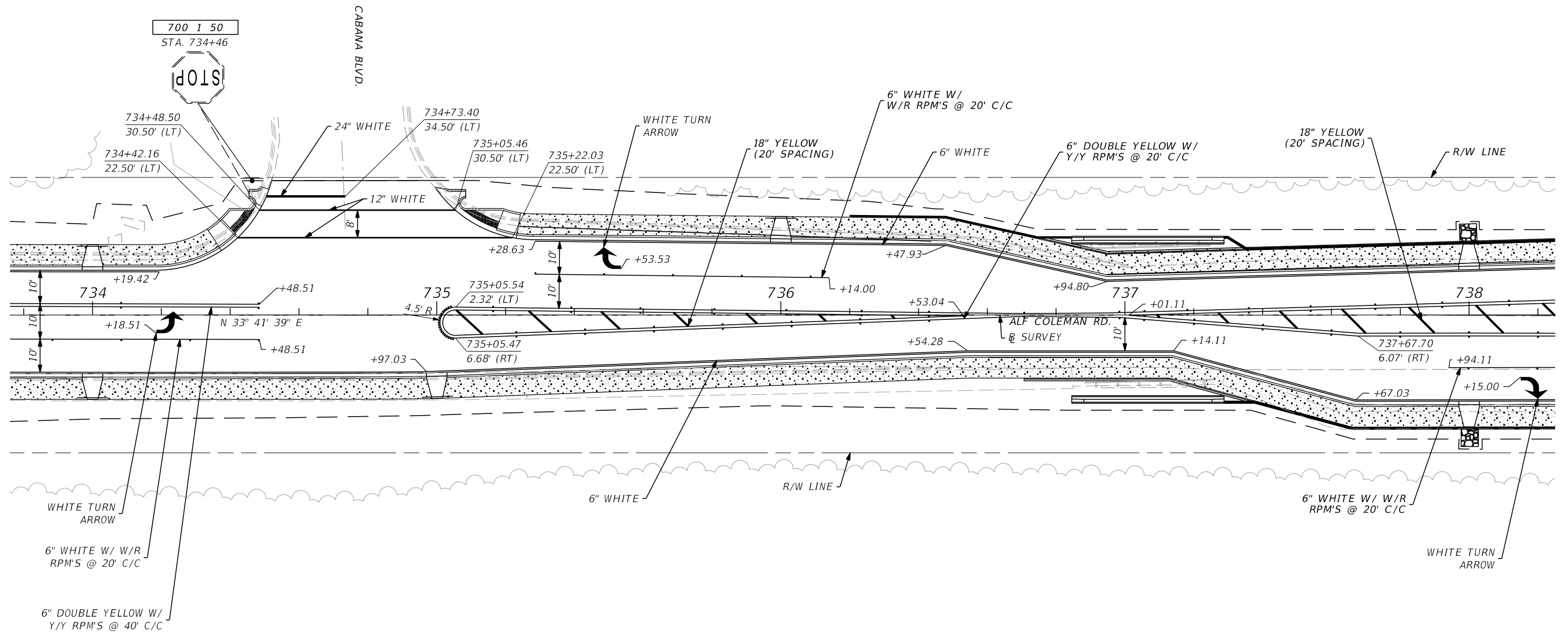
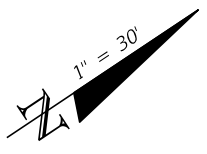

REVISIONS				RICKY L. DODD, P.E. P.E. LICENSE NUMBER 88526 GREENMAN-PEDERSEN, INC. 1273 OFFICE PARK DR. CHIPLEY, FL 32428	STATE OF FLORIDA DEPARTMENT OF TRANSPORTATION			<b>SIGNING &amp; PAVEMENT                  MARKINGS</b>	SHEET NO.  S-7
DATE	DESCRIPTION	DATE	DESCRIPTION		ROAD NO.	COUNTY	FINANCIAL PROJECT ID		
						N/A	BAY		441742-2-58-01

THE OFFICIAL RECORD OF THIS SHEET IS THE ELECTRONIC FILE DIGITALLY SIGNED AND SEALED UNDER RULE 61G15-23.004, F.A.C.

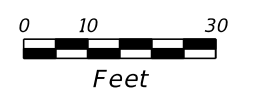
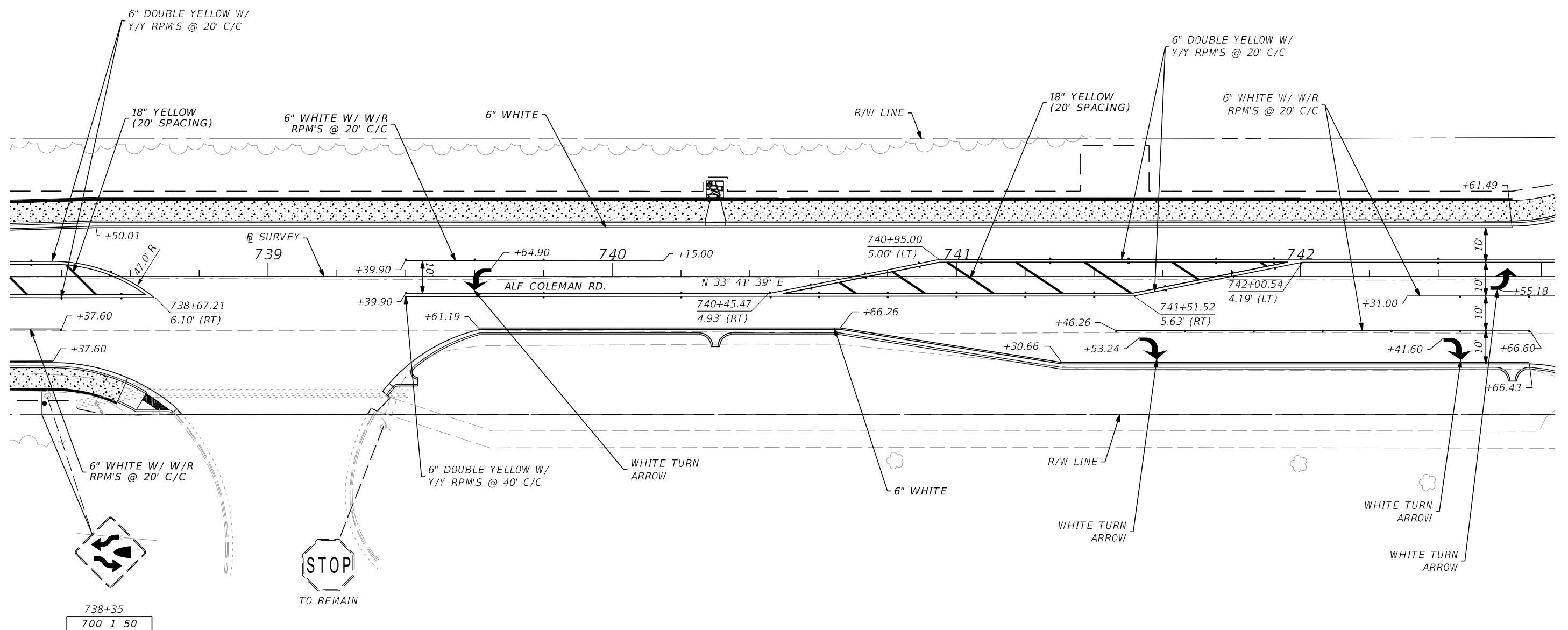
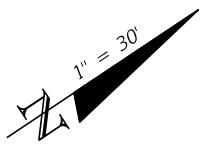

REVISIONS			
DATE	DESCRIPTION	DATE	DESCRIPTION

RICKY L. DODD, P.E.  
 P.E. LICENSE NUMBER 88526  
 GREENMAN-PEDERSEN, INC.  
 1273 OFFICE PARK DR.  
 CHIPLEY, FL 32428

STATE OF FLORIDA DEPARTMENT OF TRANSPORTATION		
ROAD NO.	COUNTY	FINANCIAL PROJECT ID
N/A	BAY	441742-2-58-01

**SIGNING & PAVEMENT  
 MARKINGS**

SHEET NO.  
 S-8

THE OFFICIAL RECORD OF THIS SHEET IS THE ELECTRONIC FILE DIGITALLY SIGNED AND SEALED UNDER RULE 61G15-23.004, F.A.C.



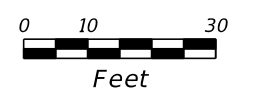
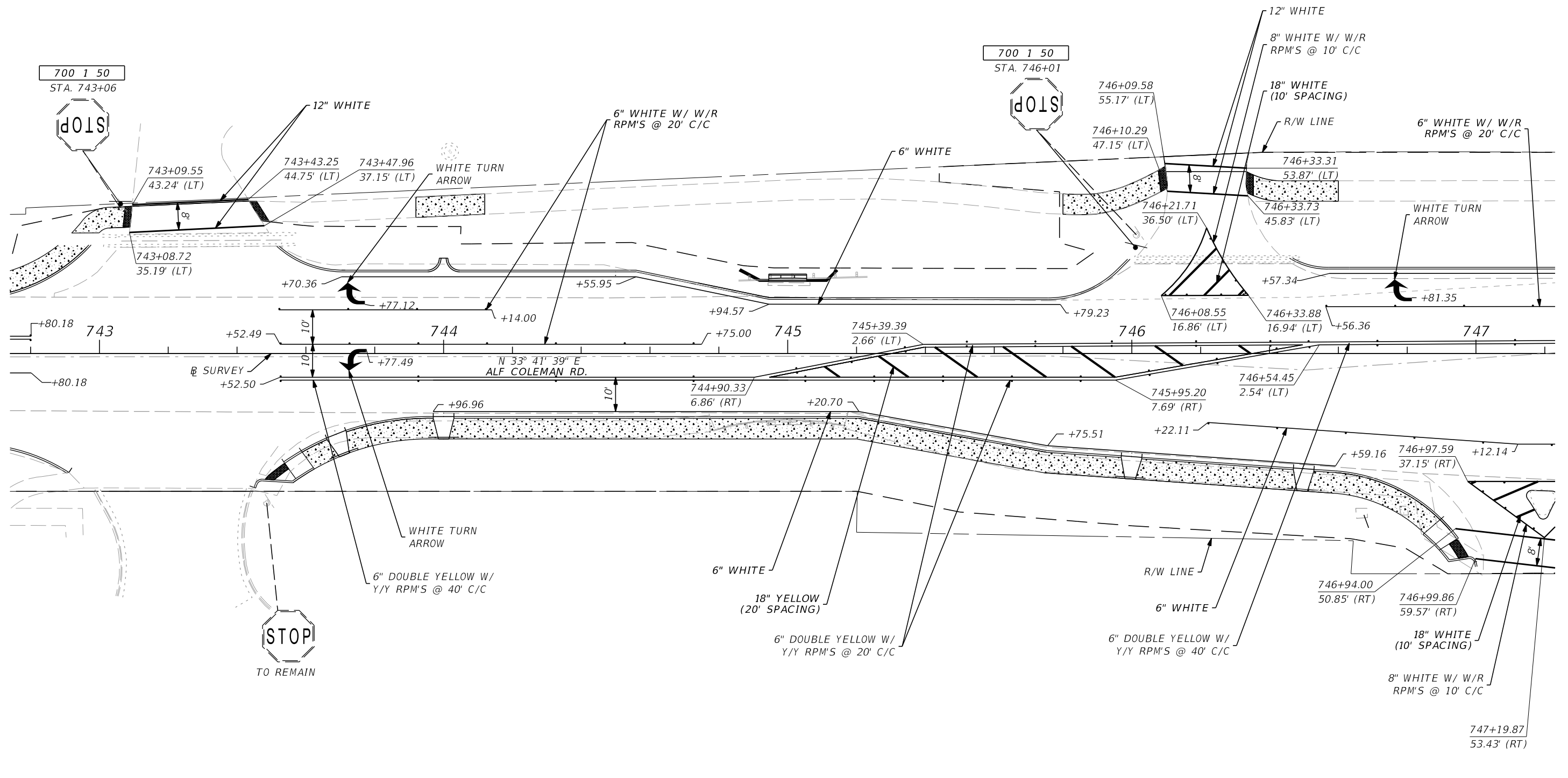
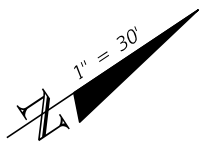

REVISIONS			
DATE	DESCRIPTION	DATE	DESCRIPTION

RICKY L. DODD, P.E.  
 P.E. LICENSE NUMBER 88526  
 GREENMAN-PEDERSEN, INC.  
 1273 OFFICE PARK DR.  
 CHIPLEY, FL 32428

STATE OF FLORIDA DEPARTMENT OF TRANSPORTATION		
ROAD NO.	COUNTY	FINANCIAL PROJECT ID
N/A	BAY	441742-2-58-01

**SIGNING & PAVEMENT  
 MARKINGS**

SHEET NO.  
 S-9

THE OFFICIAL RECORD OF THIS SHEET IS THE ELECTRONIC FILE DIGITALLY SIGNED AND SEALED UNDER RULE 61G15-23.004, F.A.C.

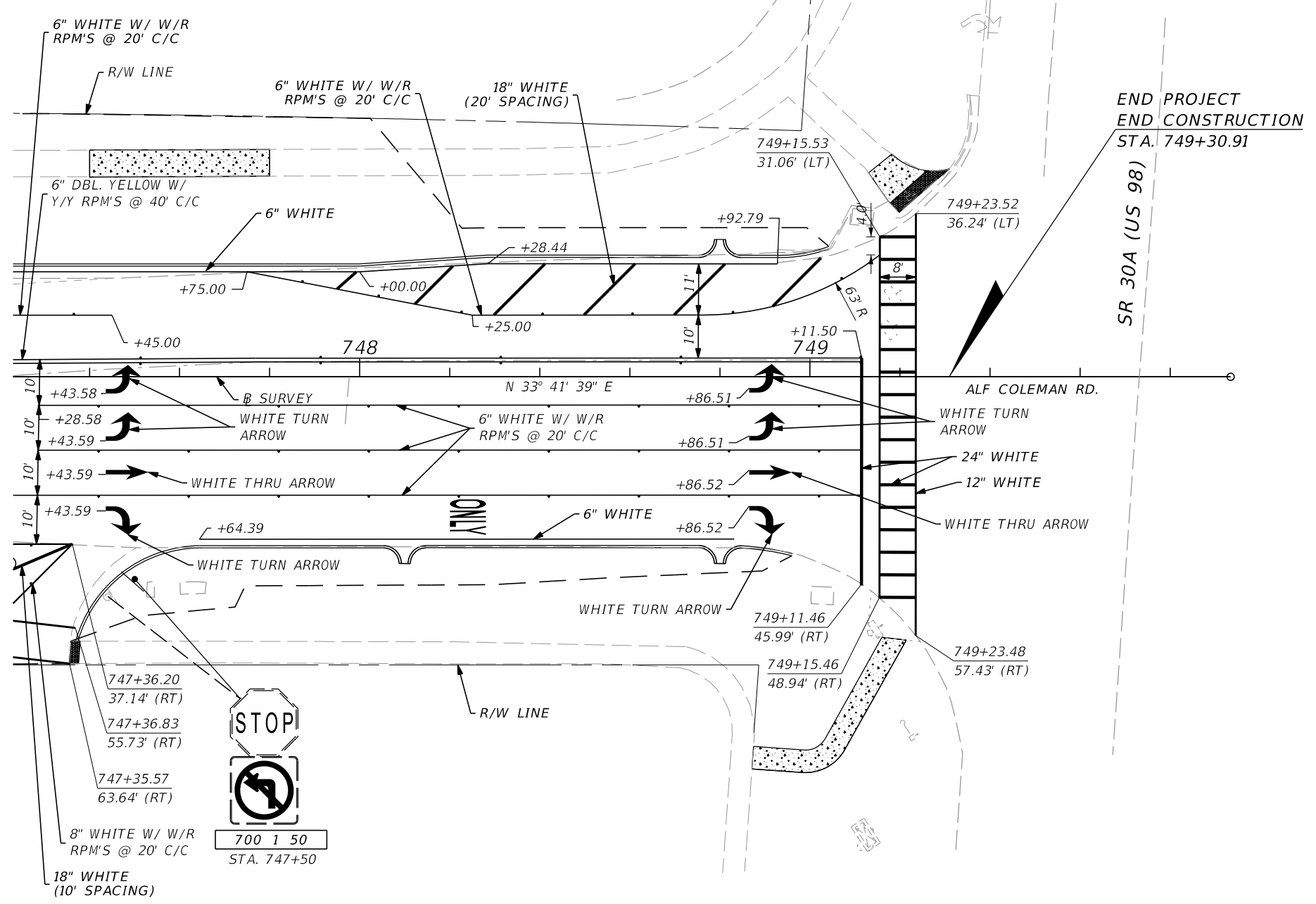
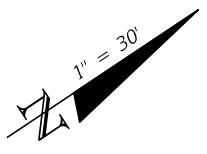

END PROJECT  
END CONSTRUCTION  
STA. 749+30.91

SR 30A (US 98)

ALF COLEMAN RD.

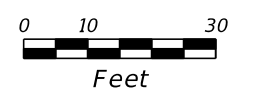

REVISIONS				RICKY L. DODD, P.E. P.E. LICENSE NUMBER 88526 GREENMAN-PEDERSEN, INC. 1273 OFFICE PARK DR. CHIPLEY, FL 32428	STATE OF FLORIDA DEPARTMENT OF TRANSPORTATION			SIGNING AND PAVEMENT MARKINGS	SHEET NO.
DATE	DESCRIPTION	DATE	DESCRIPTION		ROAD NO.	COUNTY	FINANCIAL PROJECT ID		
						N/A	BAY		441742-2-58-01

THE OFFICIAL RECORD OF THIS SHEET IS THE ELECTRONIC FILE DIGITALLY SIGNED AND SEALED UNDER RULE 61G15-23.004, F.A.C.